

ITEM NO.	PART DESCRIPTION	QTY.
1	Pair of Modified Premium Runners	1
2	Narrow Premium Handle	1
3	Pair of Adaption Bars	1
4	M8 x 16mm Button Head Bolt	4
5	M8 x 20mm Button Head Bolt	4
6	M8 Nyloc Nut	4
7	M8 Rear Slot Washer	2
8	Seatbelt Bracket (Variable Dependant on Seat Model)	1
9	Seatbelt Spacer Bar	1
10	OEM Floor Fixing Bolts from Original Seat	4

SUBPOR007 at 292mm

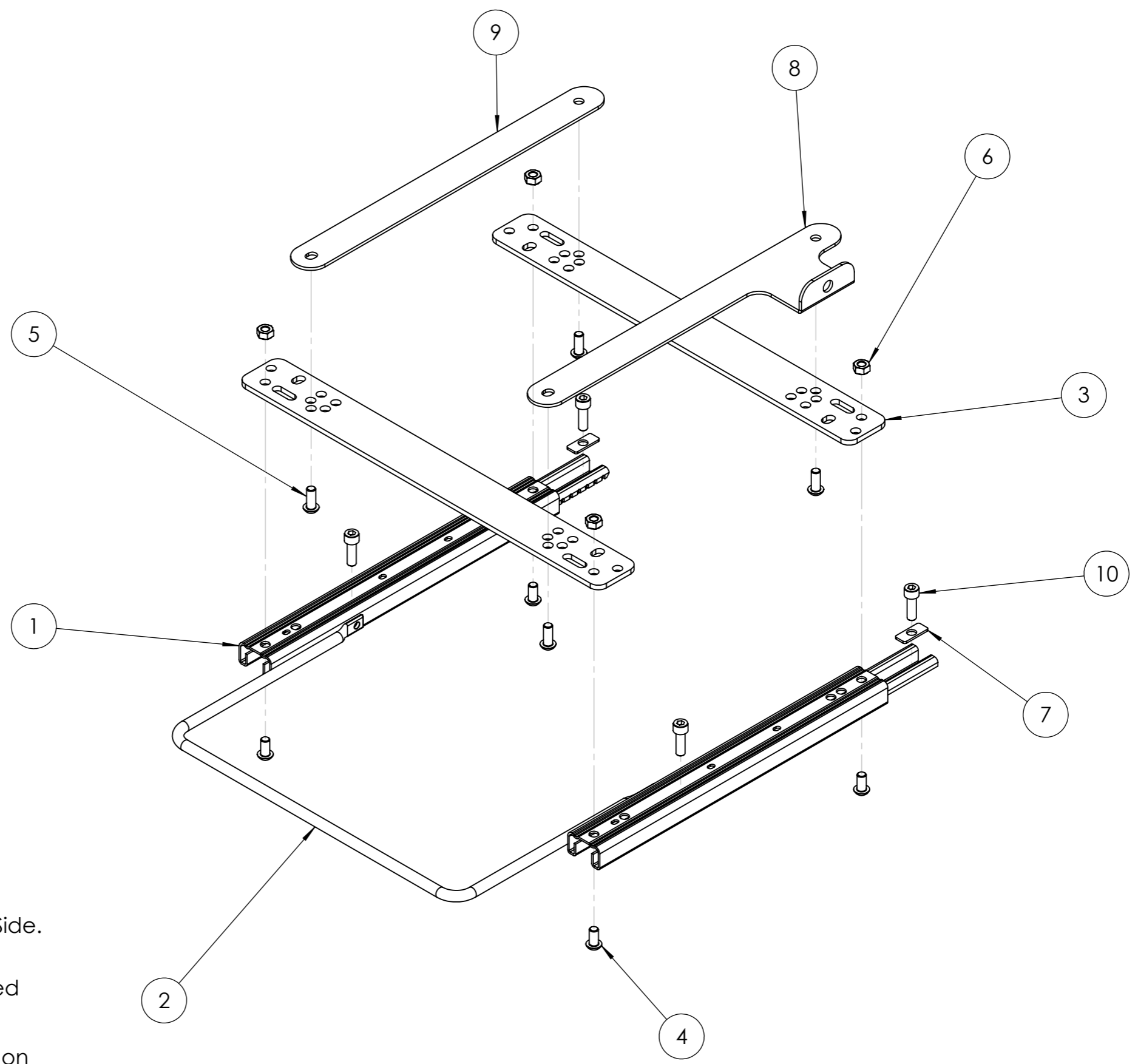

NOTE: This drawing is configured for UK Driver's Side. For UK Passenger Side, the Spacer Bar and the Seatbelt Brackets must be on opposite sides in relation to this drawing. Therefore, a Left-Handed Seatbelt Bracket will be required.

When fixing the frame to the floor, use OE bolts on ALL 4 fixing points.