

#### KIT CONTENTS

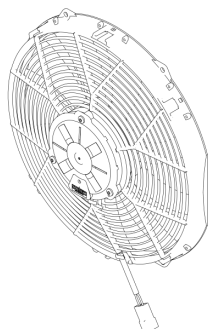

☐ 12" SUCTION FAN  
Part No. FAN0607HP  
x2

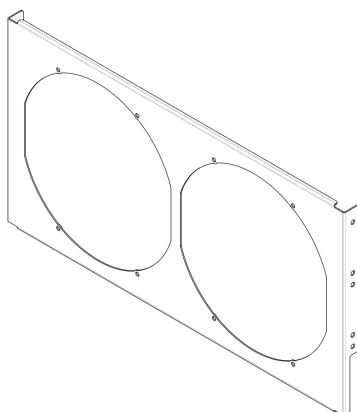

☐ S3 SHROUD  
Part No. 130034  
x1



M6 x 16mm Flange Bolt  
x4



M6 Nyloc Nut  
x4



M6 Washer Form A  
(Small Diameter)  
x4

☐ BOLT KIT M6 X4  
Part No. 140005  
x2 Kits

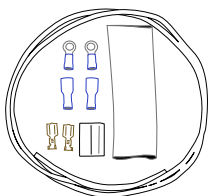

☐ TWIN FAN EARTH KIT  
Part No. 140029  
x1 Kit

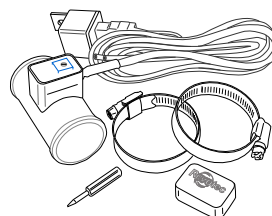

ELECTRONIC FAN CONTROLLER  
Part No. EFC38  
x1 Kit

☐ NEGATIVE EARTH / ☐ POSITIVE EARTH

SIGNED OFF BY: \_\_\_\_\_ DATE: \_\_\_\_\_

#### FUSE SIZING

To prevent damage if a cooling fan gets blocked, the circuit powering the fan needs a time-delay type fuse with the correct amperage rating.  
This installation uses 2x suction fans - part number FAN0607HP (F27P-12E8102-41S).  
The nominal combined current of both (**connected in parallel**) is 22 amps.

#### IMPORTANT NOTES

This Revotec cooling kit has been engineered to provide perfect cooling for your Jaguar E-Type Series 3. However it is essential that the other components in the cooling system are operating correctly. The following must be checked:

**1.The radiator has a normal life expectancy of approximately 8-9 years, after this time it should be thoroughly assessed and any signs of deterioration, such as furring up internally or distortion, a replacement is recommended.**

**2.The radiator fins must be clear of all debris such as mud and leaves.**

**3.The system must be filled with the correct coolant.**

**4. The water pump and thermostat must be operating correctly.**

**5. This kit is designed to fit original, unmodified vehicles only.**

Installations are to be undertaken by a competent vehicle mechanic.

If in doubt, consult a qualified professional.

Always work in a safe environment and wear PPE where necessary.

Disconnect the vehicle battery before beginning installation.

Failure to comply with the above may result in your warranty being void.

## STEP 1

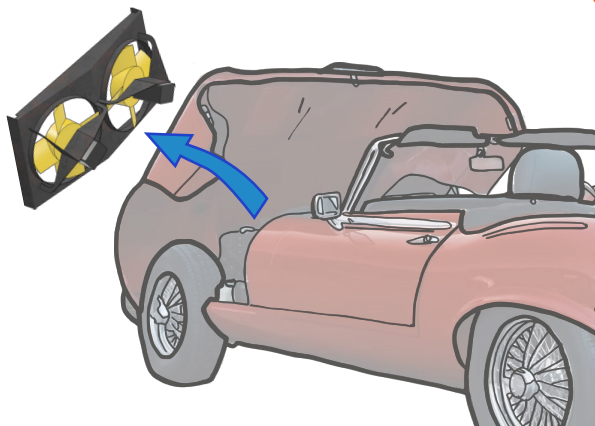

Disconnect the vehicle battery and remove the original fan shroud assembly according to the workshop manual. Remove the radiator side retaining bolts and keep in a safe place for re-installation. For this kit installation, the radiator can remain in-situ.

## STEP 2

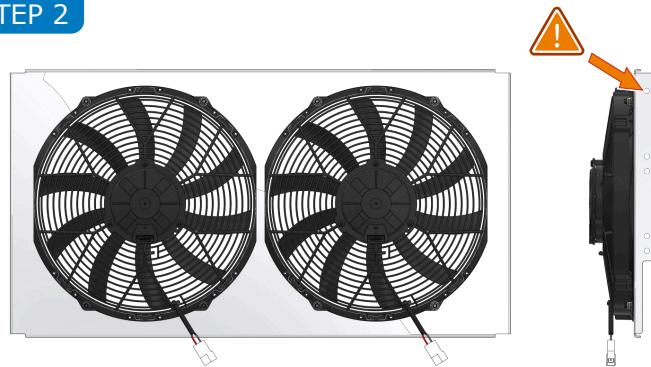

Lay the supplied shroud down on a workbench and align the fans as shown above. Note, the holes down the side of the shroud are offset toward the top of the shroud. Ensure the hole nearest the top of the side return is at the top.

## STEP 3

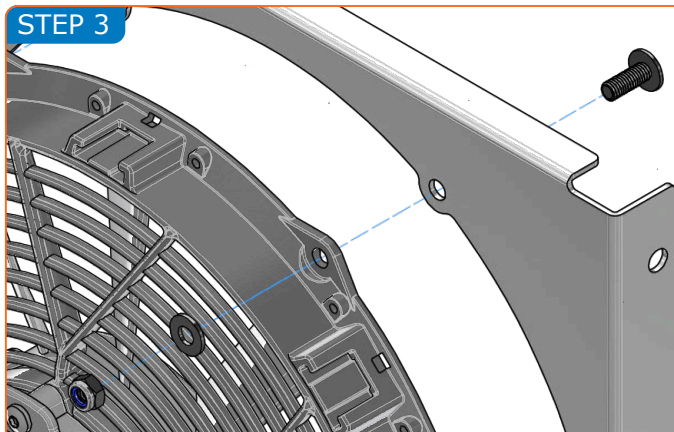

Using the supplied M6 fixing kits, secure the fans to the shroud. The flange head fixings are positioned through the shroud as shown - with the thread facing out. The fans fit flush against the fan shroud with a washer dropped on each thread before fully securing with a nyloc nut on each. Do not over-tighten.

## STEP 4

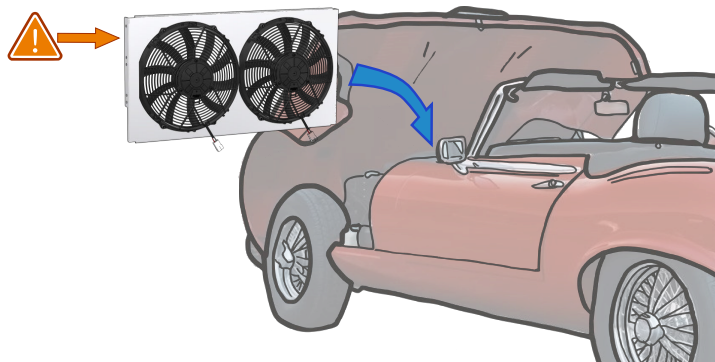

Carefully guide the fan and shroud assembly up to the rear of the radiator, ensure the fan cables are not snagged. Note the offset holes are closer to the top of the shroud.

## STEP 5

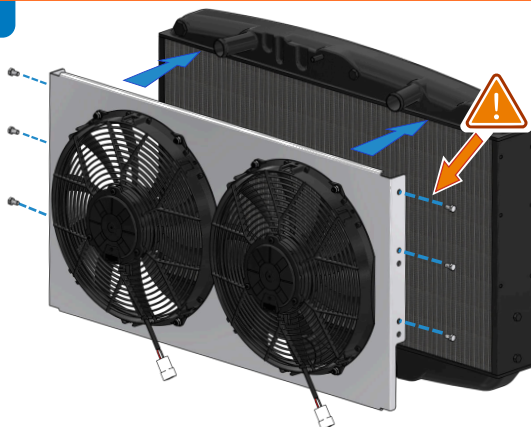

The fan and shroud assembly attaches to the radiator in place of the original fan shroud, using the existing side fixing points. Use the bolts saved from step 1 to secure the fan kit to the radiator. Ensure the fans are free-spinning and that the assembly is not twisted. Check there is a uniform gap around the fan blades.

## STEP 6

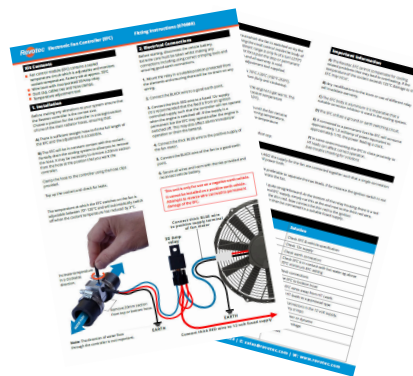

Refer to EFC and twin fan earth kit fitting instructions included for the next stage of installation, prior to reconnecting hoses and refilling with coolant.