

KIT CONTENTS

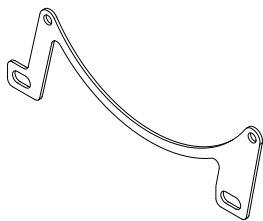

☐ OUTER FAN BRACKET
Part No. 130075
x2

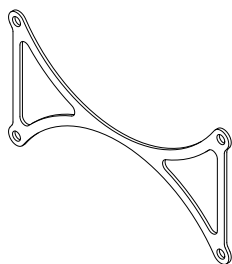

☐ LOWER FAN BRACKET
Part No. 130074
x1

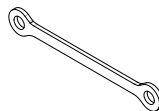

☐ CENTRE BRACE
Part No. 130076
x2

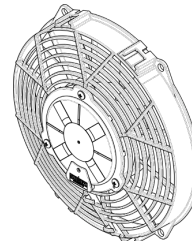

☐ 9" BLOWING FAN
Part No. FAN0127
x1

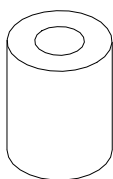

☐ M6 NYLON SPACER
Part No. 140010
x1 Kit (x4 TOTAL)

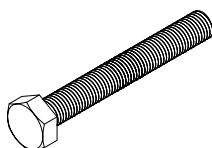

☐ M8 x 60mm BOLT KIT
Part No. 140044
x1 Kit (x4 TOTAL)

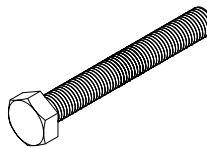

☐ 5/16" UNF x 60mm BOLT KIT
Part No. 140045
x1 Kit (x4 TOTAL)

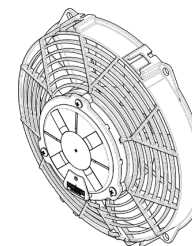

☐ 9" BLOWING FAN
Part No. FAN0610
x1

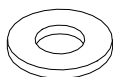

☐ M8 WASHER KIT
Part No. 140054
x1 Kit (x12 TOTAL)



☐ M8 NUT KIT
Part No. 140048
x1 Kit (x4 TOTAL)



☐ 5/16" NUT KIT
Part No. 140002
x1 Kit (x4 TOTAL)

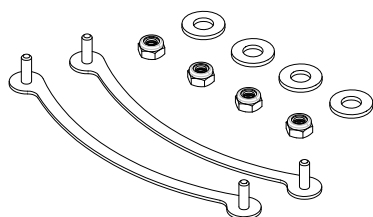

☐ 225mm FLUSH MOUNTS
Part No. FM225
x2 Kits (x4 TOTAL)

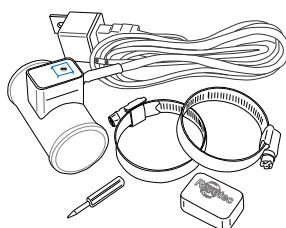

☐ ELECTRONIC FAN CONTROLLER
Part No. EFC35
x1 Kit

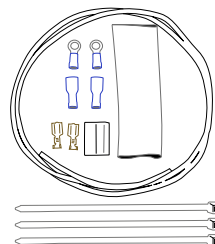

☐ TWIN FAN EARTH KIT
Part No. 140029
x1 Kit

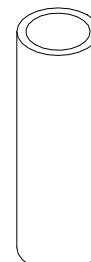

☐ M8x35 STEEL SPACER
Part No. 140011
x1 Kit (x4 TOTAL)

SIGNED OFF BY: _____ DATE: _____

FUSE SIZING

To prevent damage if a cooling fan gets blocked, the circuit powering the fan needs a time-delay type fuse with the correct amperage rating.
This installation uses 2x 9" blowing fans - part numbers FAN0127 (F26P-12E8001-10B) and FAN0610HP (F26P-12E8102-10B)
The nominal combined running current of both (connected in parallel) is 16.5amps.

IMPORTANT NOTES

This Revotec cooling kit has been engineered to provide perfect cooling for your MGB V8. However it is essential that the other components in the cooling system are operating correctly. The following must be checked:

1.The radiator has a normal life expectancy of approximately 8-9 years, after this time it should be thoroughly assessed and any signs of deterioration, such as furring up internally or distortion, a replacement is recommended.

2.The radiator fins must be clear of all debris such as mud and leaves.

3.The system must be filled with the correct coolant.

4. The water pump and thermostat must be operating correctly.

5. This kit is designed to fit original, unmodified vehicles only.

Installations are to be undertaken by a competent vehicle mechanic.
If in doubt, consult a qualified professional.

Always work in a safe environment and wear PPE where necessary.

Disconnect the vehicle battery before beginning installation.

Failure to comply with the above may result in your warranty being void.

STEP 1

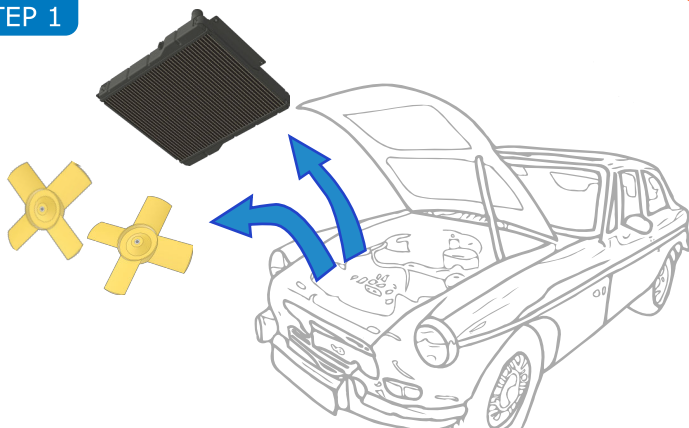

Disconnect the vehicle battery and drain the vehicle coolant system. Remove the radiator, fan shroud and fans according to the workshop manual. Remove the upper and lower radiator bolts that secure the radiator to the front bulkhead.

STEP 2

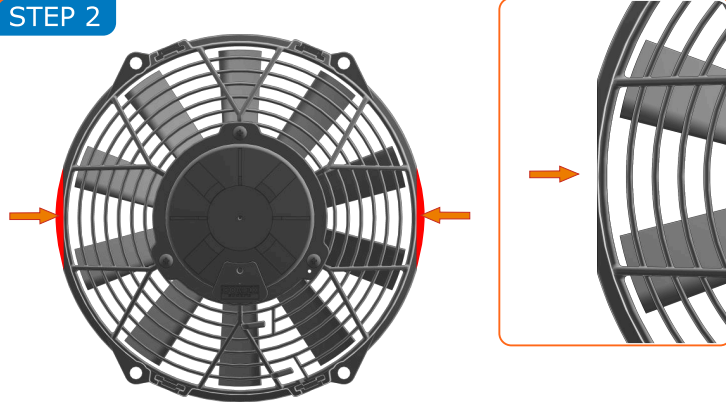

To allow fan fitting, the supplied fans feature a removable edge that needs trimming. Use a pair of side cutters (or similar) to trim the two side edges back to the straight edge (shown above).

STEP 3

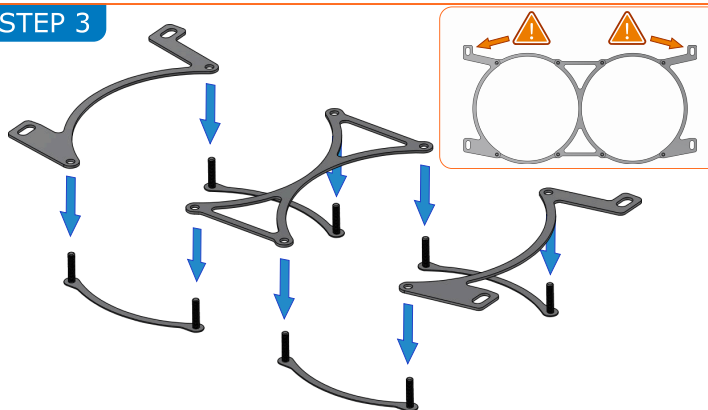

With reference to the above image, lay the flush mounts in their rough orientation on a flat surface. Slide the centre and outer brackets over the flush mount protruding studs as shown. Ensure the outer brackets are orientated as shown in the corner image - the tabbed lobes are at the top.

STEP 4

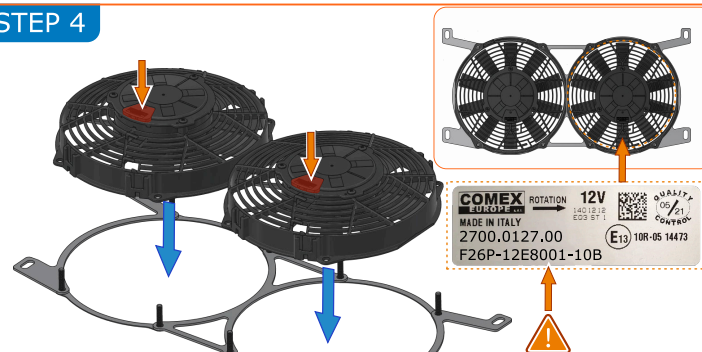

As the two supplied fans are of a different type - ensure the F26P-12E8001-10B fan (see sticker on the side of the plastic shroud), is positioned on the right hand side of the assembly. Slide the fan shroud fixing holes over the protruding studs. Note - the cable entry positions (highlighted red above) are to be at the bottom.

STEP 5

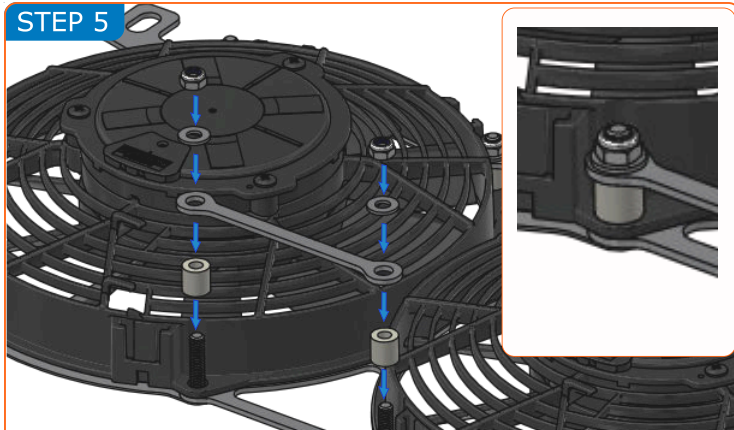

Position the four supplied nylon spacers over each of the four innermost flush mount protruding studs. Two centre braces are required to branch the upper and lower stud pairs. Place one of the supplied M6 washers on each of the four studs and loosely fit the M6 nyloc nuts as shown above. Do not tighten at this stage.

STEP 6

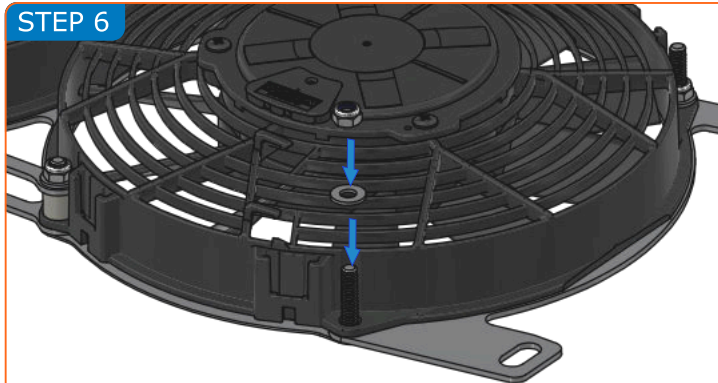

The four remaining outer studs require an M6 washer and M6 nyloc nut to be loosely fitted at this stage.

STEP 7

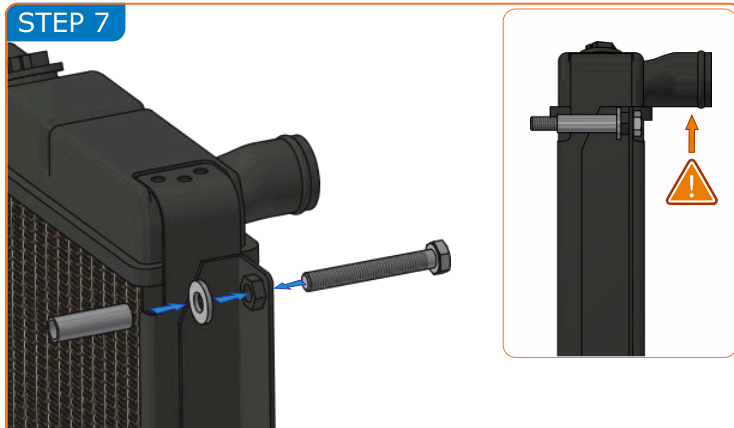

This kit contains metric (M8) and Imperial (5/16" UNF) bolts. Carefully test-fit which ones suit your radiator before screwing the four suitable bolts into the radiator side brackets, facing away from the hose connectors (see above image). Slide one large washer and steel spacer sleeve over each protruding bolt.

STEP 8



Test fit the assembly by laying the radiator on a flat surface with the bolts fitted in Step 7 facing up. Fit the fan assembly over the protruding studs and check alignment.

STEP 9

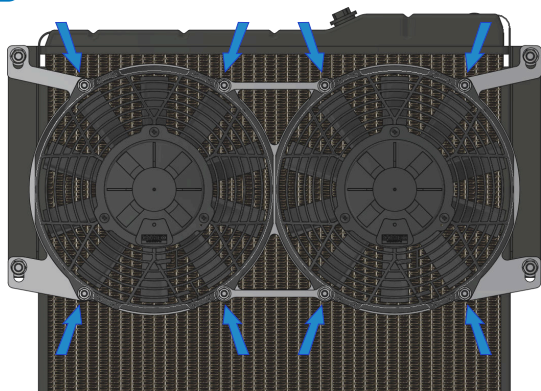

From the innermost fixings outward, tighten the assembly fixings. Be careful not to over-tighten. Ensure the fans are free-spinning and that the assembly is not twisted. Check there is a uniform gap around the fan blades.

STEP 10



The radiator and fan assembly cannot be fitted as one. To enable this, remove the fan assembly from the radiator at this stage. Withdraw the long bolts from the side of the radiator, taking care to store the washers and spacers for use in step 12.

STEP 11

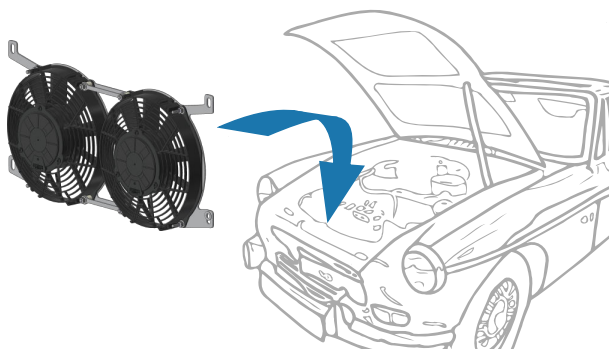

The fan assembly needs to be stowed behind the vehicle grille whilst the radiator is refitted. With the bracket tabs facing upward and the fans aligned as shown above, place the fan assembly in the vehicle and hold behind the front grille.

STEP 12

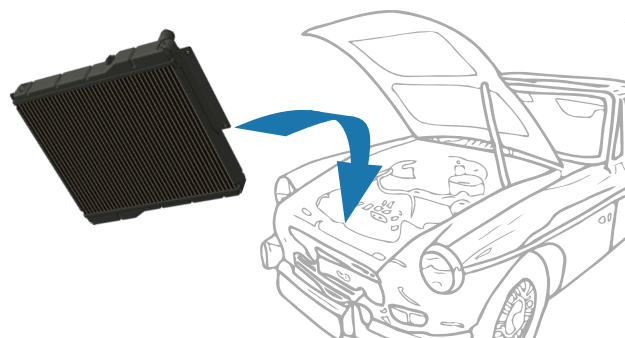

Re-fit and attach the radiator to the vehicle mounting points using the 60mm long bolts removed in step 10.

STEP 13

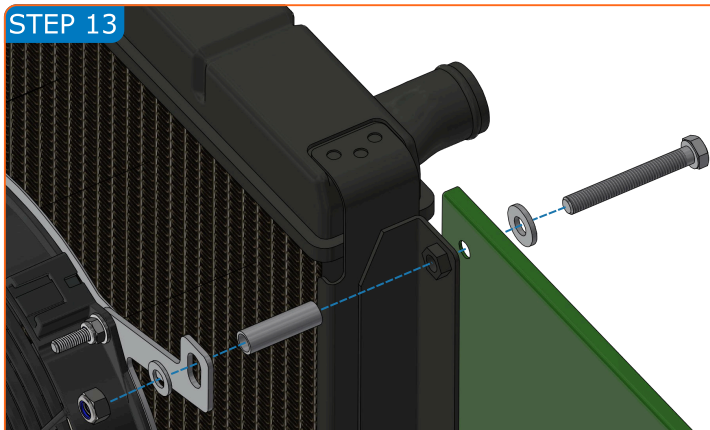

Slide the M6 washer over the 60mm bolt before inserting through the mounting hole in the vehicle body (shown above in green). Slide the spacer tubes over the protruding bolts, then position the fan assembly over the bolts before securing with another M6 washer and a fully tightened M6 nyloc nut.

STEP 14

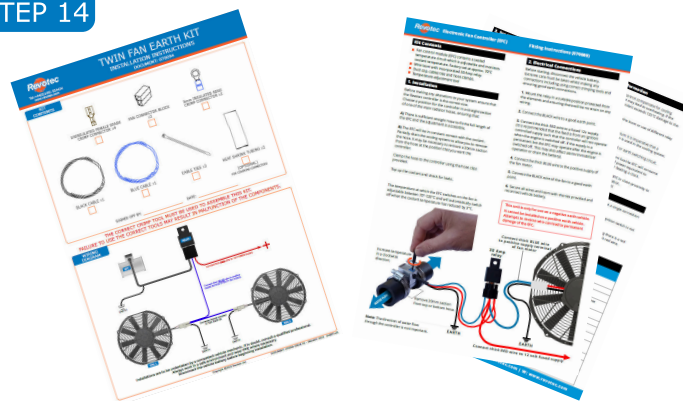

Re-fill and bleed the coolant system according to the owners manual. Refer to the Twin Fan Earth Kit and EFC35 fitting instructions for next steps.