

Car	BMW M3 F80	Part No.	SBMS073CF
Year	2014-2018	Fit Kits	267FK
Notes	Where not supplied use original fittings. The original system requires cutting in a specific point, see instructions on the next page.	Features	Pipe Diameter:- 70mm

Estimated Fitting Time: 2 Hours

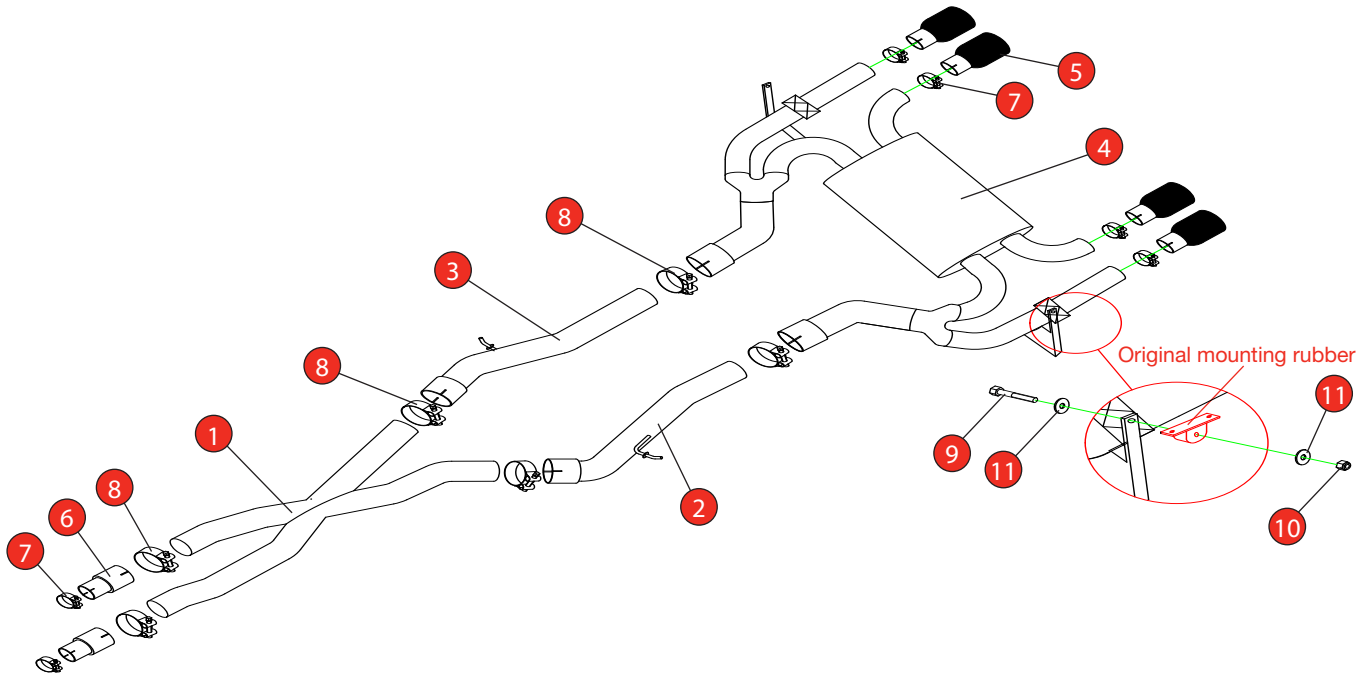

NO.	PART NO.	DESCRIPTION	QTY
1	721BM	Crossover Centre Section	1
2	722BM	L/H Link Pipe	1
3	723BM	R/H Link Pipe	1
4	724BM	Rear Silencer	1
5	Z023.10158	Carbon Fibre Ascari Trim	4
Fit Kit			
6	AD90	Adaptor	2
7	Z016.10064	65.9mm H/D Clamp	6
8	Z016.10063	72.4mm H/D Clamp	6
9	Z017.10107	M10 x 50mm Hex Head Bolt	2
10	Z017.10103	M10 Nyloc Nut	2
11	Z017.11014	M10 x 25mm Washer	4
12	Z017.10609	M6 x 16mm Cap Head Bolt (See valve instructions on the next page)	6
13	Z017.10617	M6 x 12mm Washer (See valve instructions on the next page)	6
14	Z017.12783	BMW Fixing Bow (See valve instructions on the next page)	2
15	Z026.10004	Ø20 x 10mm Alloy Spacer (See instructions on the next page)	6

E-MARK	N/A
DATE	12/08/20
ISSUE	00
AUTHORISED	M.YDLIBI

NOTE: ENSURE SCORPION FITTINGS ARE CLEAR OF MOVING PARTS AND ALL ORIGINAL FUNCTIONS WORK CORRECTLY.



STAY CONNECTED TO RED POWER.

Car	BMW M3 F80	Part No.	SBMS073CF
Year	2014-2018	Fit Kits	267FK
Notes	Where not supplied use original fittings	Features	Pipe Diameter:- 70mm

Estimated Fitting Time: 2 Hours

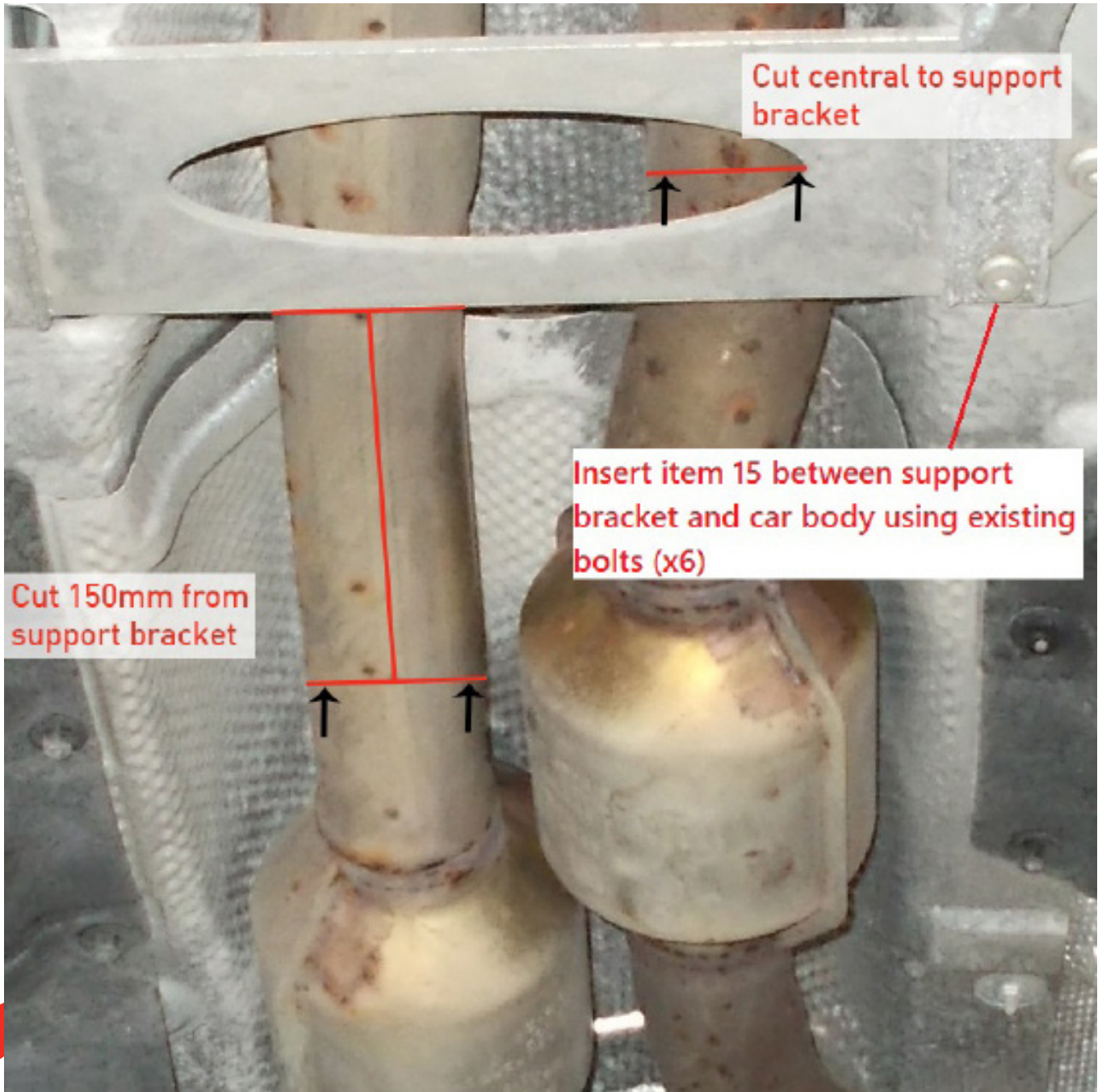

Car	BMW M3 F80	Part No.	SBMS073C
Year	2014-2018	Fit Kits	267FK
Notes	Where not supplied use original fittings	Features	Pipe Diameter:- 70mm

Estimated Fitting Time: 2 Hours



A) Remove the electronic actuator from the original exhaust.



B) On the scorpion product fit the fixing bow (item 14) into the valve and use the actuator to secure the bow in place.

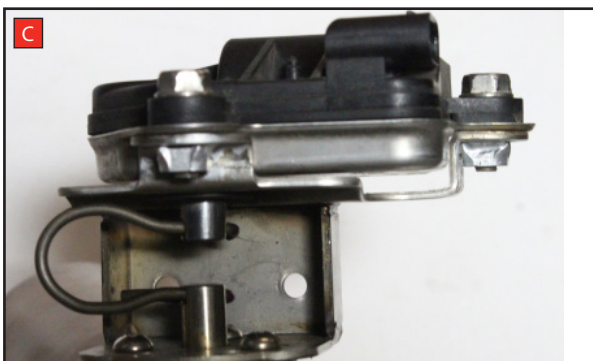

C) Use the M6 bolts and washers (items 12 & 13) to fasten the actuator to the valve ensuring the two straights on the fixing bow fit between the grooves on both of the posts.



STAY CONNECTED TO RED POWER.