

<b>Car</b>	Honda Civic Type R FK8 R/H Drive	<b>Part No.</b>	SHDS015
<b>Year</b>	2017-Current	<b>Fit Kits</b>	288FK
<b>Notes</b>	Where not supplied use original fittings	<b>Features</b>	Pipe Diameter:- 76mm

Estimated Fitting Time: 2 Hours 30 Minutes

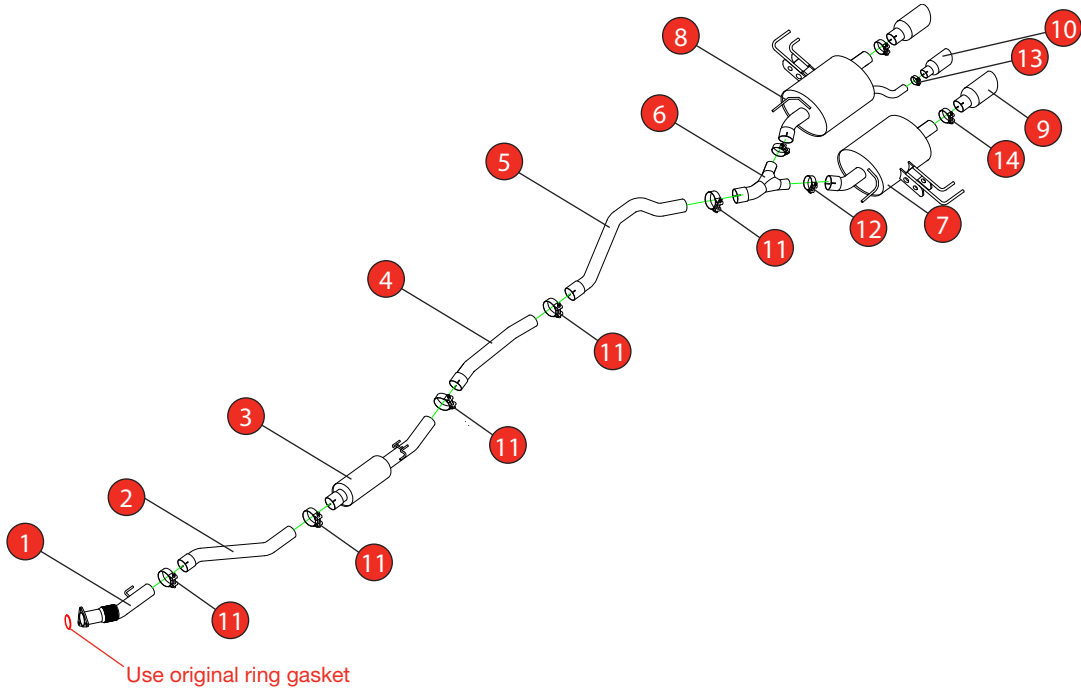

NO.	PART NO.	DESCRIPTION	QTY
1	252HA	Front Flex Pipe	1
2	253HA	Front Link Pipe	1
3	255HA	Resonated Front Section	1
4	257HA	Non-resonated Centre Section	1
5	258HA	Rear Link Pipe	1
6	259HA	Y Piece	1
7	260HA	L/H Rear Silencer	1
8	261HA	R/H Rear Silencer	1
9	Z038.10160	Ø114mm Polished Indy Trim	2
10	Z043.10185	Ø90mm Polished Indy Trim	1
<b>Fit Kit</b>			
11	Z016.10062	79mm H/D Clamp	5
12	Z016.10070	66mm H/D Clamp	2
13	Z016.10007	40-43mm Clamp	1
14	Z016.10064	63-68mm Clamp	2

E-MARK	N/A
DATE	04/04/18
ISSUE	01
AUTHORISED	M.Ydlibi

**NOTE:** ENSURE SCORPION SYSTEM IS CLEAR OF MOVING PARTS AND ALL ORIGINAL FUNCTIONS WORK CORRECTLY.



STAY CONNECTED TO RED POWER.