

MAZDA MX5 MKIII

Stainless Steel Sports Grille Kit

Kit Contents: -

1. off Mesh Grille

Tools Required: -

Thin Flat Screwdriver



Mesh Grille Fitting Instructions

1. Place masking Tape around the aperture to protect the paint work, to avoid any accidental scratches to the paint work.
2. Slide the grille up under the number plate holder until the grille is central both ways in the aperture.
3. Locate the 2 side hooks through existing grille so that they hold at the back.
4. Push the lower bracket through the existing grille, while putting pressure on the front of the grille put a screwdriver through the mesh and push the clip down until it hooks behind the plastic.
5. Remove the masking tape and your grille is complete.

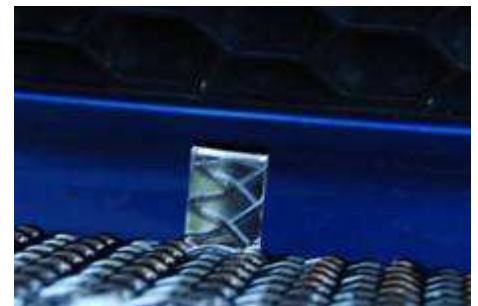
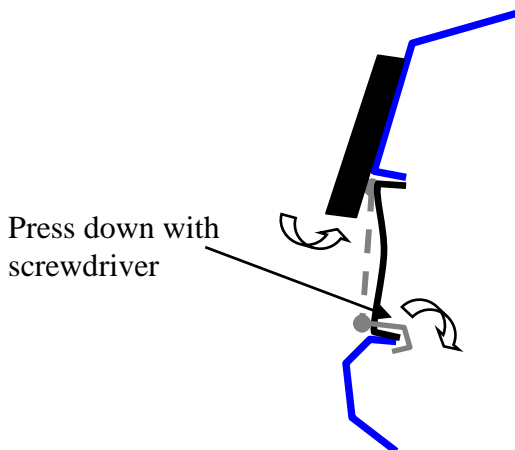

THANK YOU FOR CHOOSING A ZUNSPORT PRODUCT.